

IL PROGETTISTA



IL DIRETTORE LAVORI



IL COMMITTENTE

STUDIO DI ING. TIBERIA CORRODO  
P.L. VIA MONTANARI 19 VALTERRANA DI VERONA - 37069-  
INGEGNERIA TEL/FAX 045-520628 E-MAIL: tiberiacorrodo@tin.it

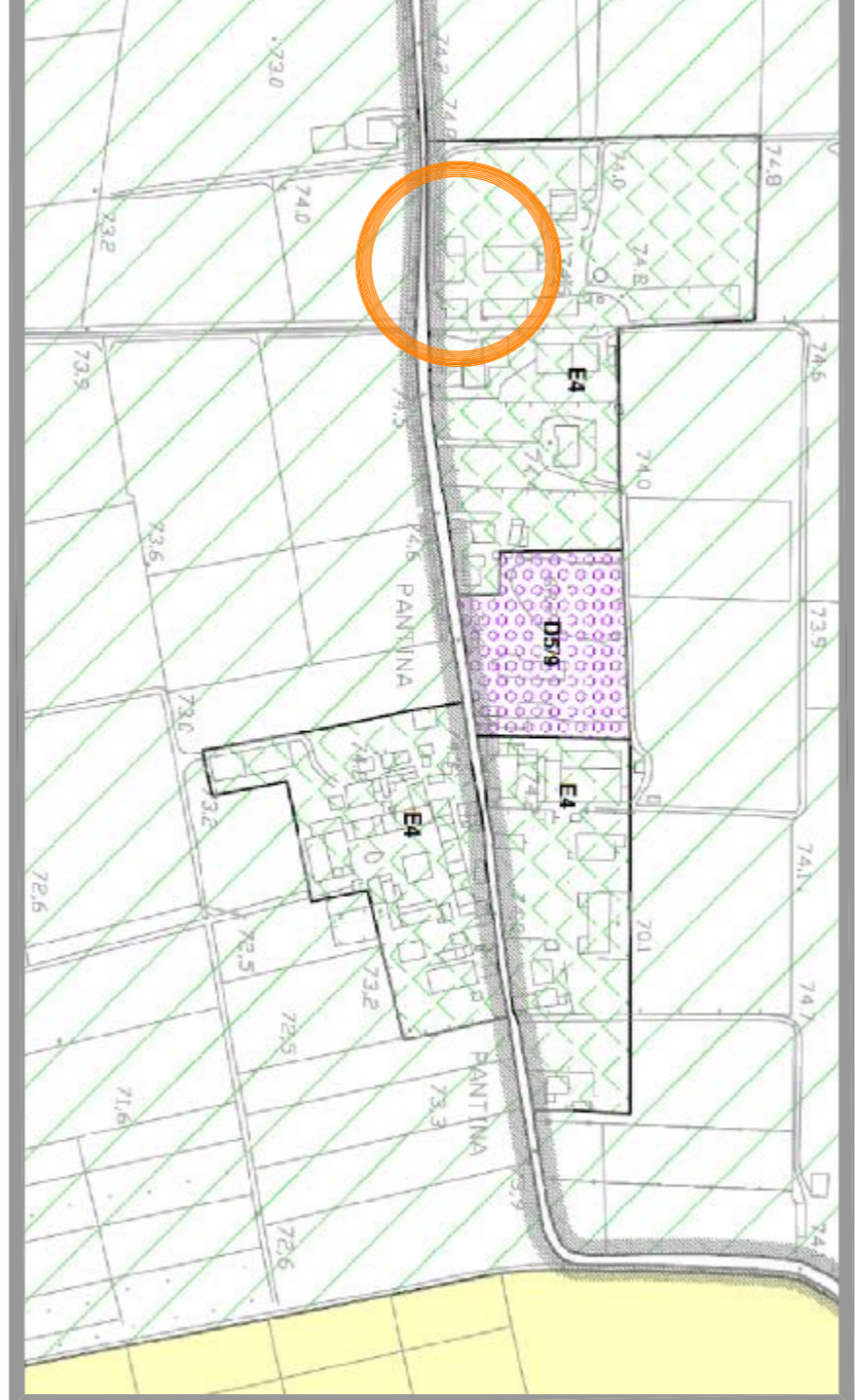

STRALCIO PRG  
Scala 1:500 zona 1F



ESTRATTO DI MAPPA CATASTALE  
Scala 1:2000  
Catasto Terreni Foglio 24 mappa n° 824

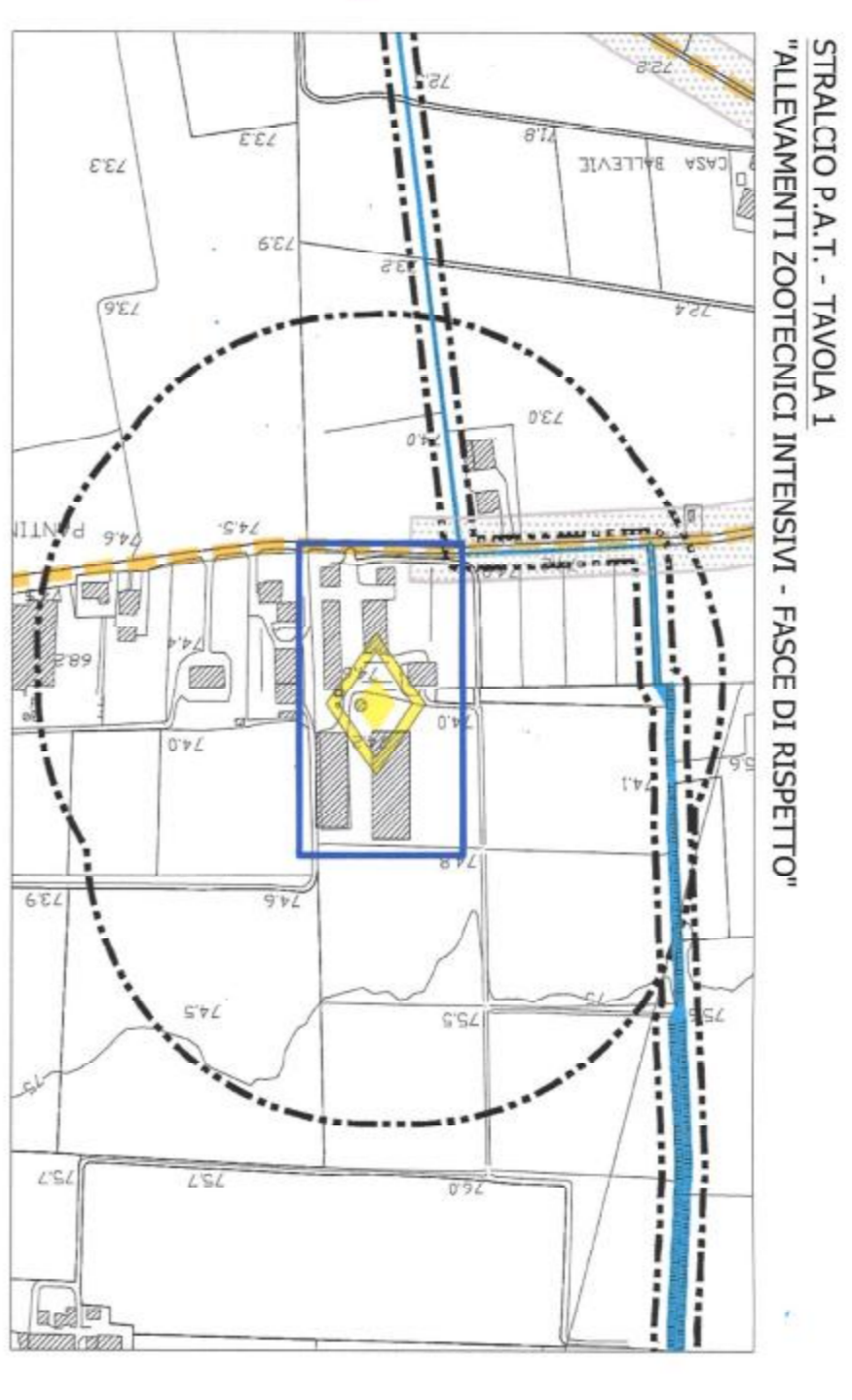

STRALCIO P.A.T. - TAVOLA 1  
VALUTAZIONE DI IMPATTO AMBIENTALE - FASCE DI RISERVA

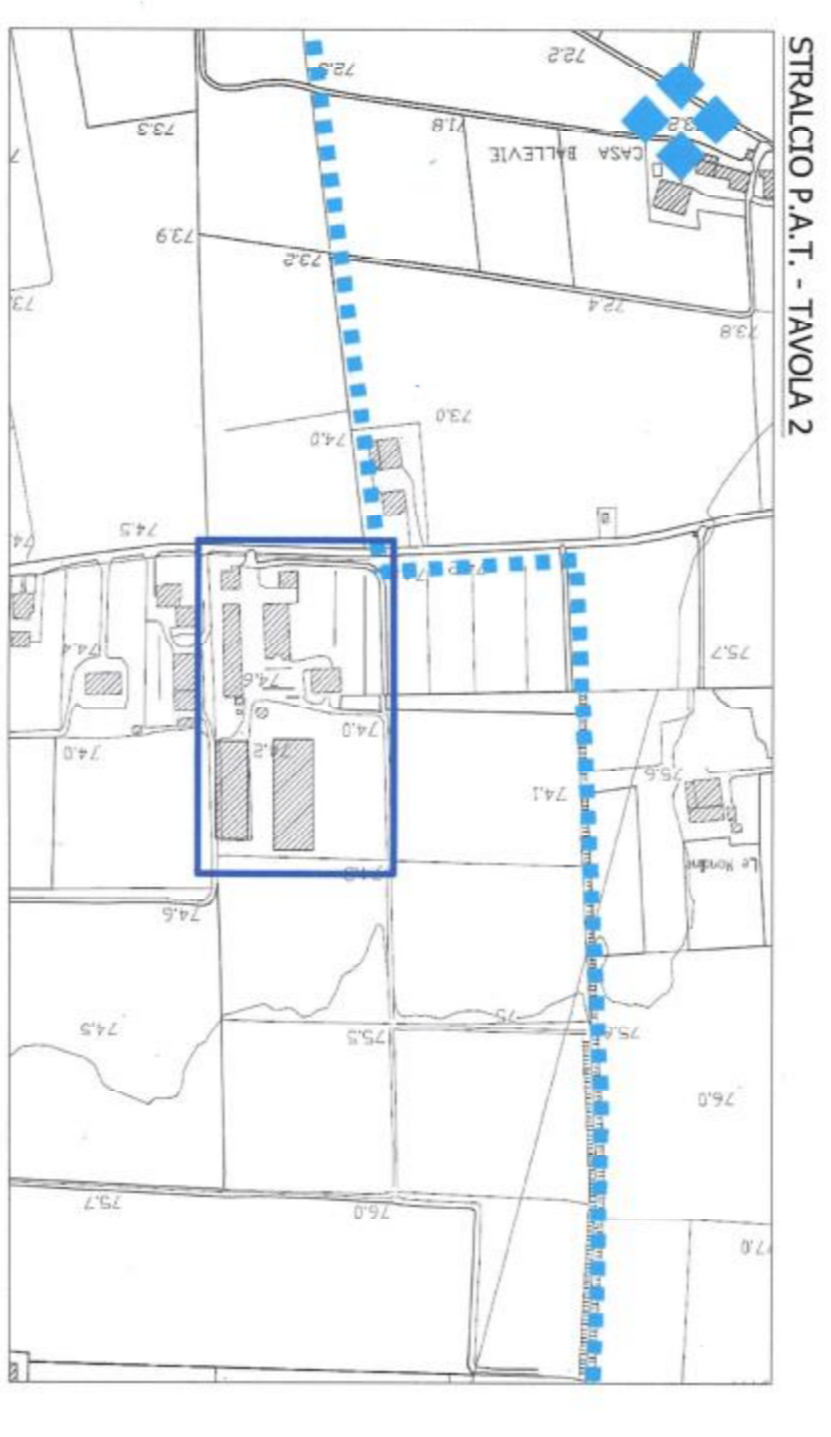

STRALCIO P.A.T. - TAVOLA 2



STRALCIO P.A.T. - TAVOLA 3  
COMPATIBILITÀ GEOLOGICA - AREA IDONEA A COSEZIONE - TAVOLA 3



STRALCIO P.A.T. - TAVOLA 4  
EDIFICAZIONE PRIFISA DI NATURA AGRICOLA - RESIDENZIALE/PRODUTTIVA

STATO APPROVATO

P.C. n°48/17 DEL 7/8/2017

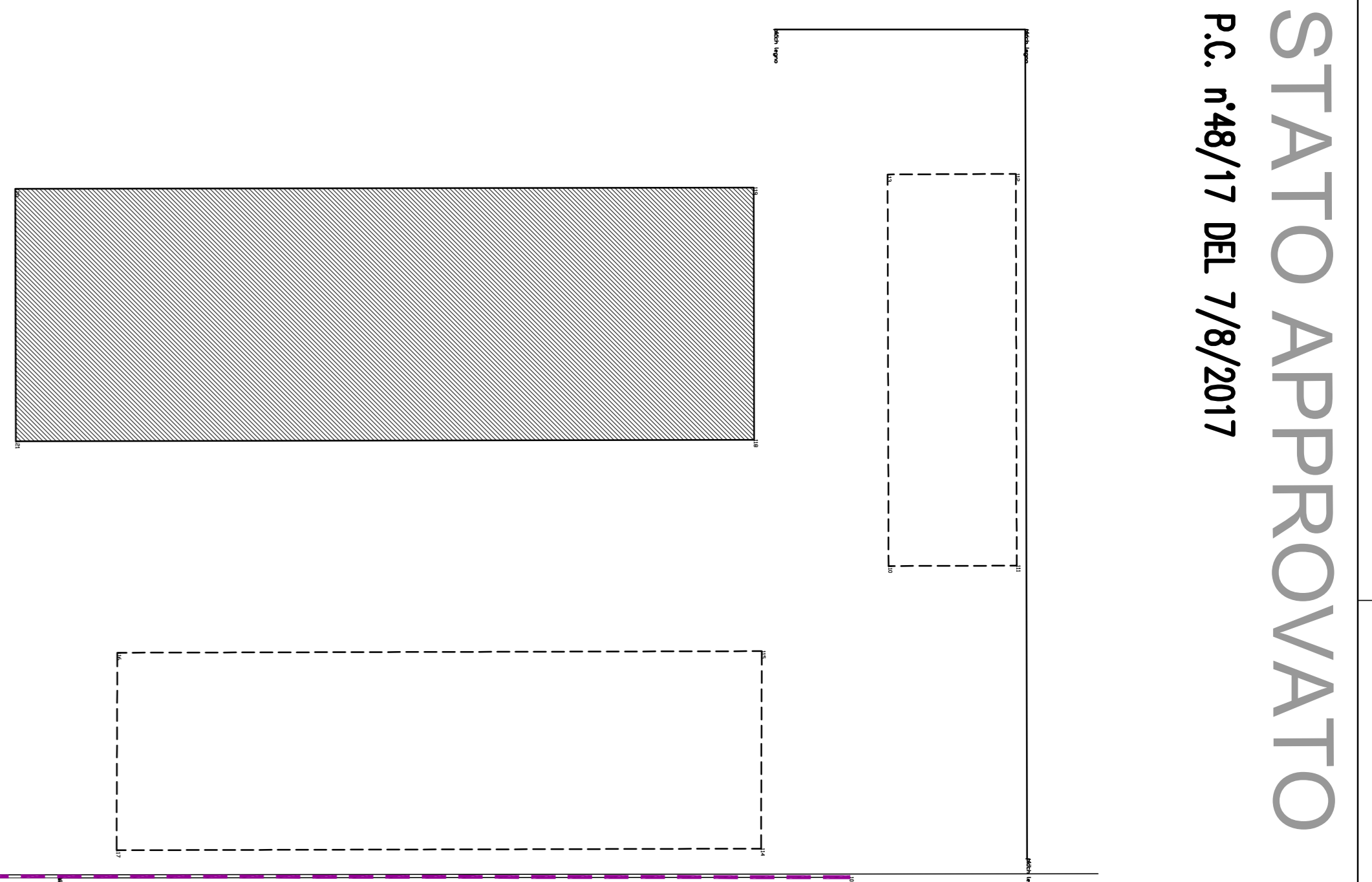
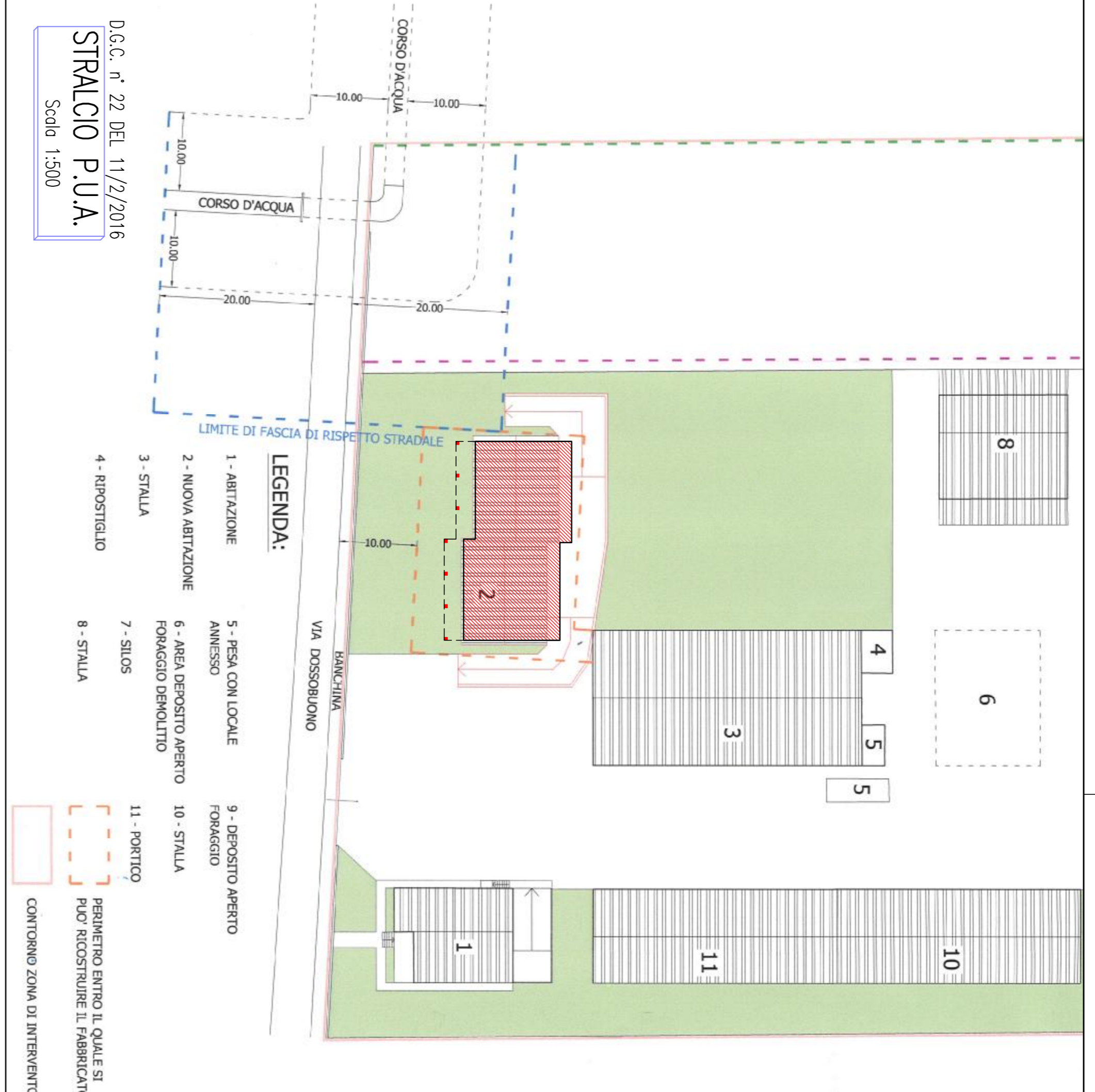

PROPOSTA DI VARIANTE

STATO di VARIANTE

SUPERICIA, VOLUMI, PROSPETTI, SACOMA, DISTRIBUZIONI INTERNE RIMANONO INVARIATI

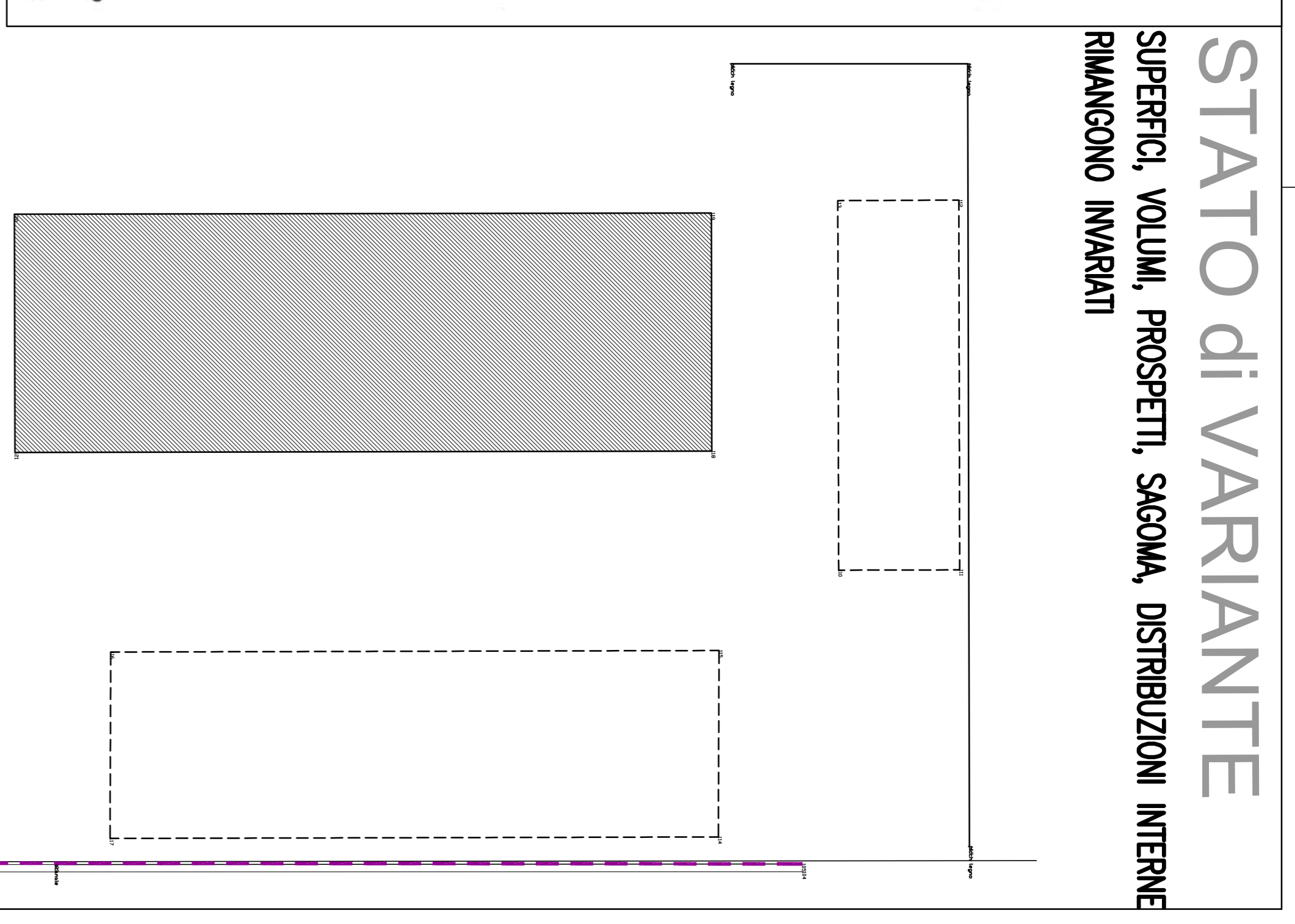

D.D.C. n° 22 DEL 11/2/2016  
**STRALCIO P.U.A.**  
Scala 1:500

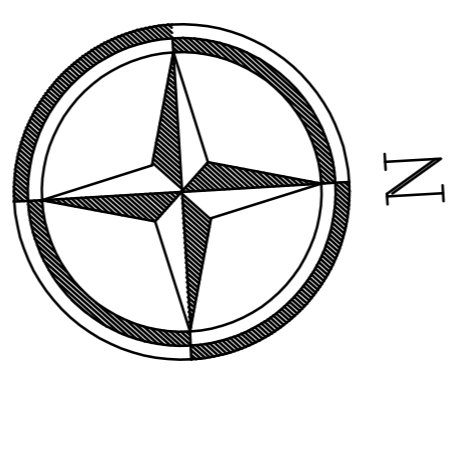
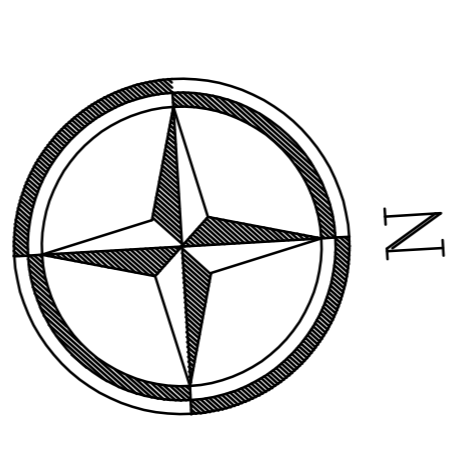
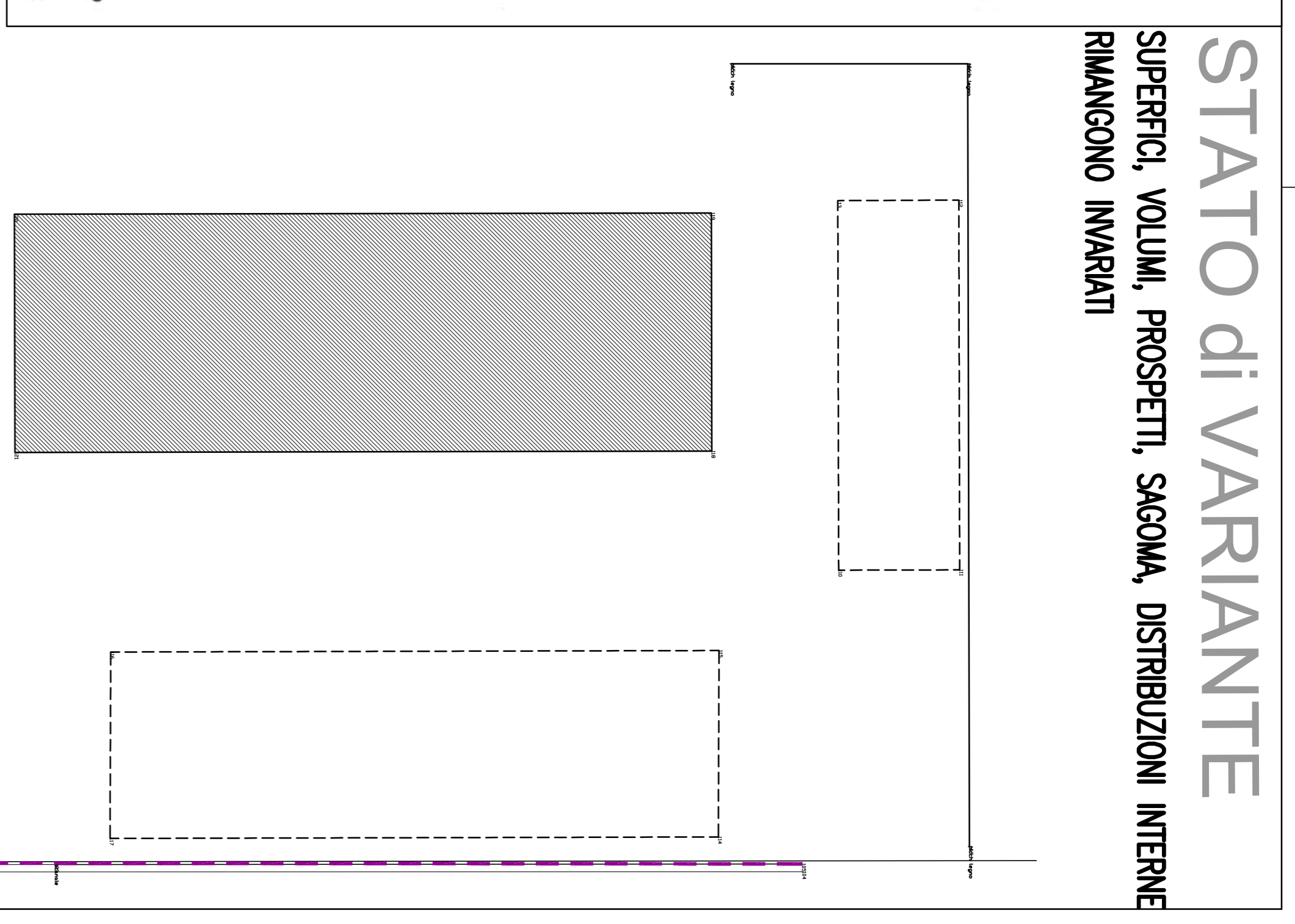
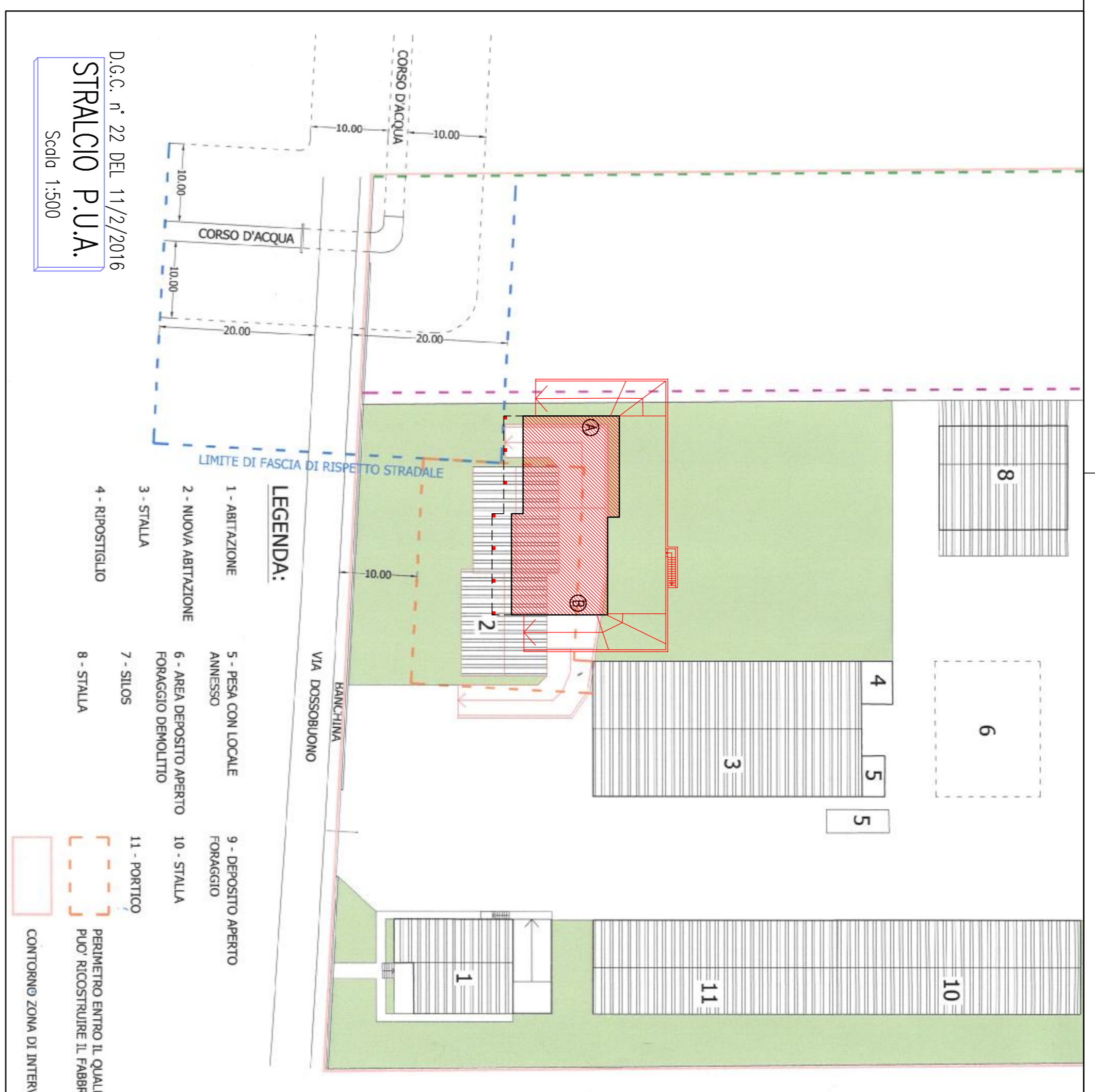
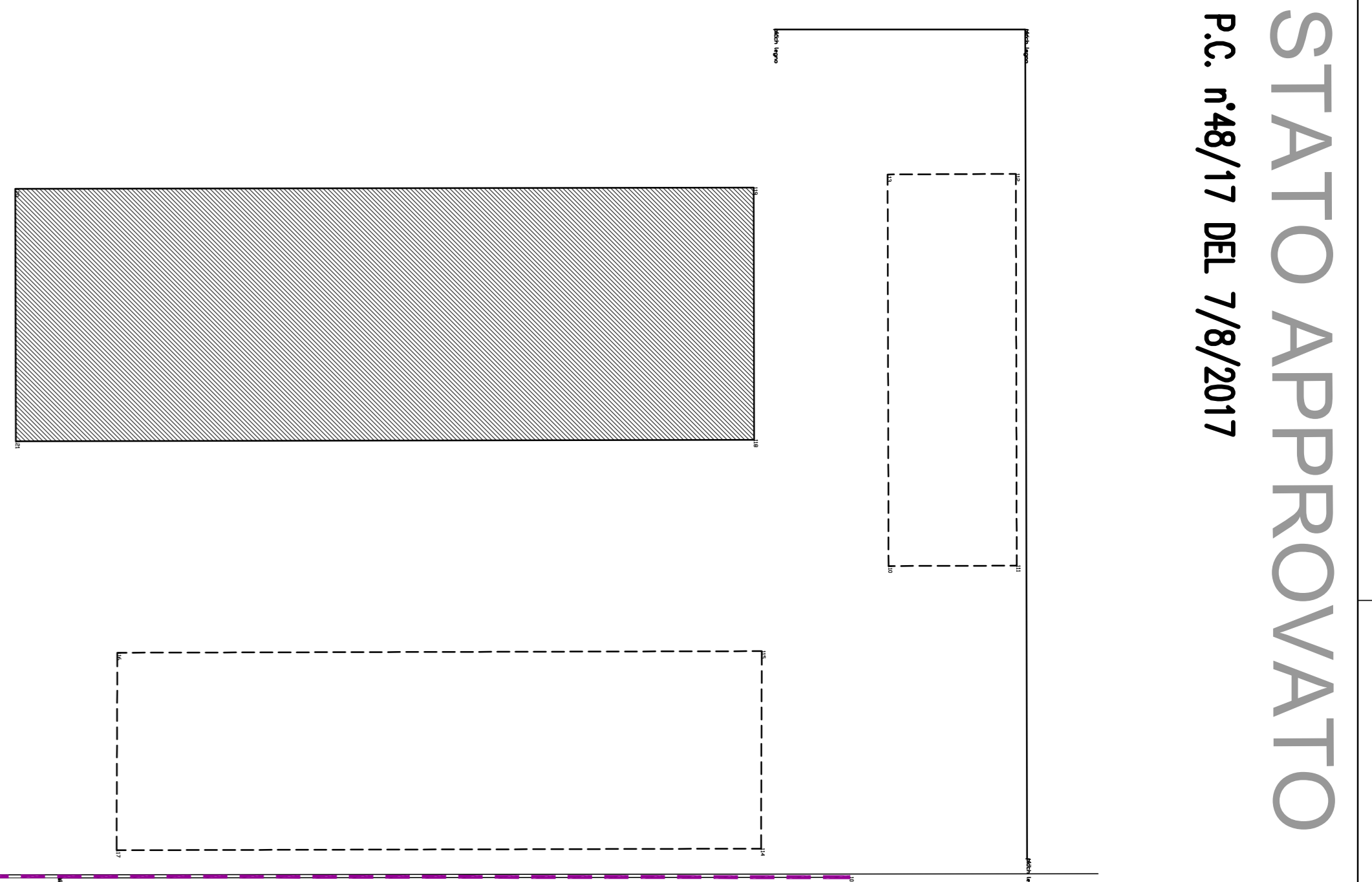

- NUOVE COSTRUZIONI VOLUME 951,58 mc
- DEMOLIZIONI VOLUME 953,96 mc
- LIMITE DI PROPRIETA'
- INVARIATO

- NUOVE COSTRUZIONI VOLUME 951,58 mc
- DEMOLIZIONI VOLUME 951,58 mc
- LIMITE DI PROPRIETA'
- INVARIATO

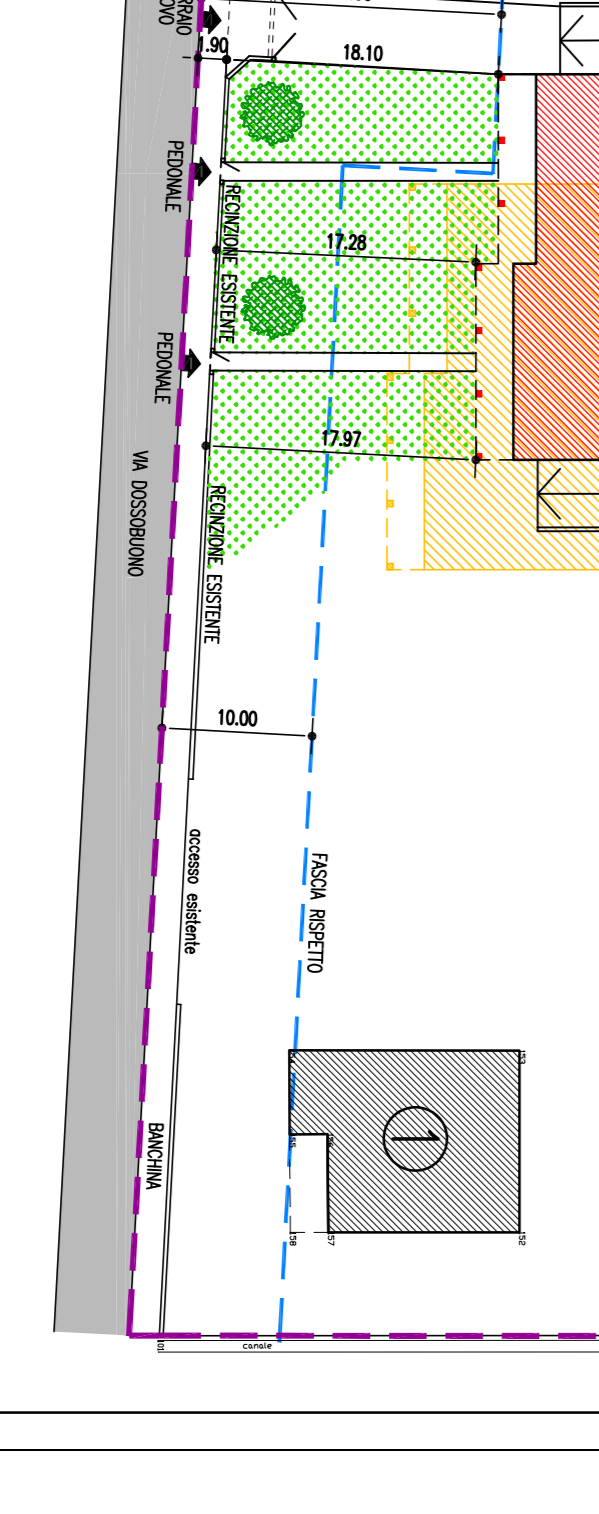
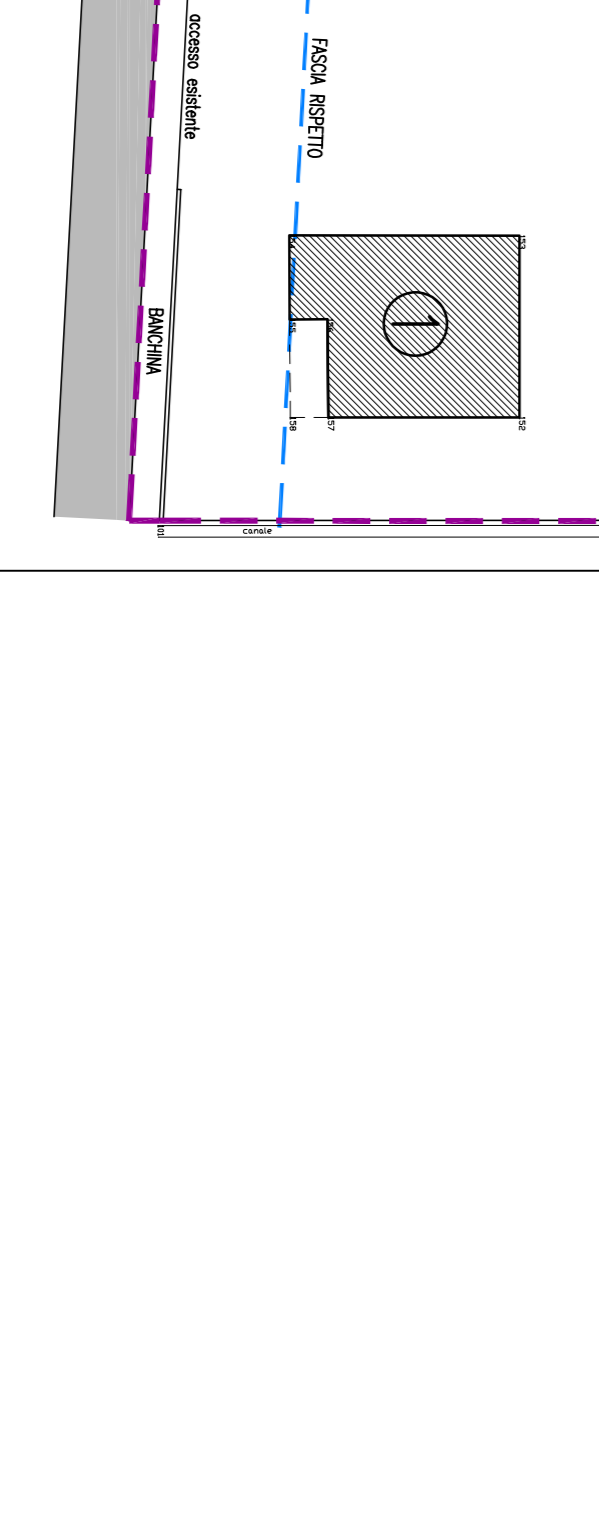
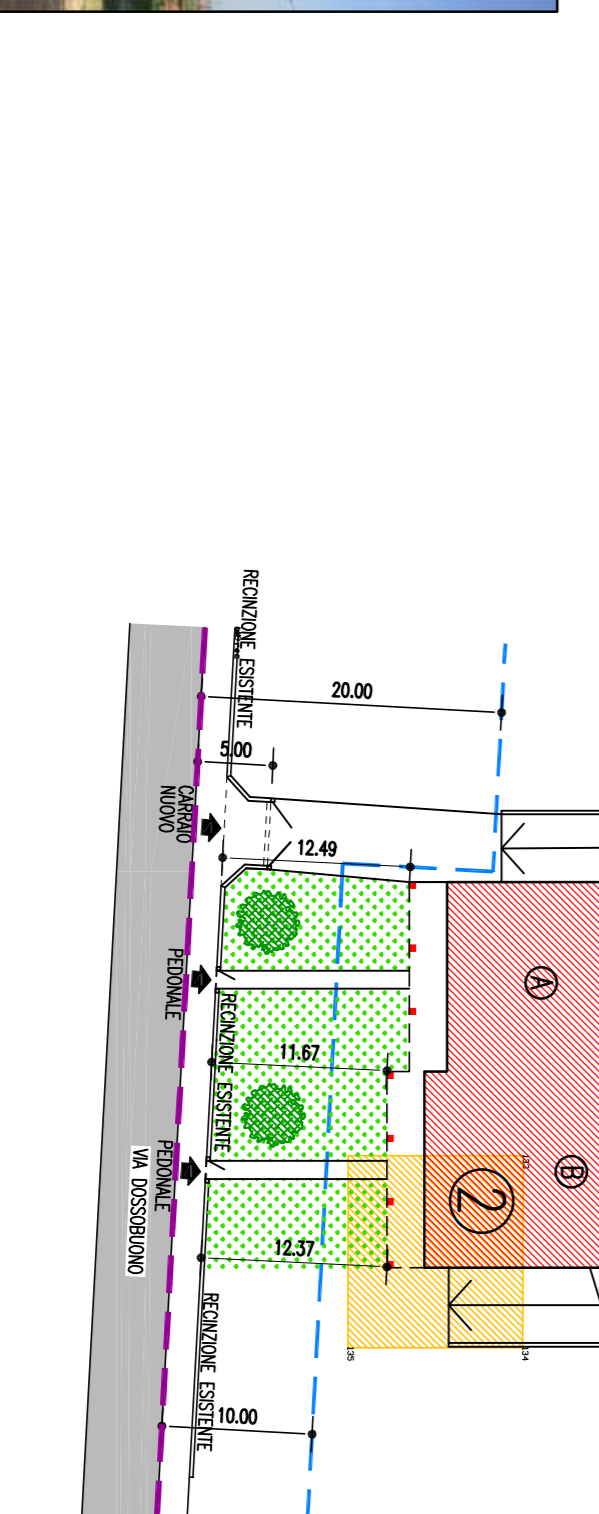

PLANIMETRIA GENERALE  
Scala 1:500

PLANIMETRIA GENERALE  
Scala 1:500